

horizontaal detail vaste pui dek-2

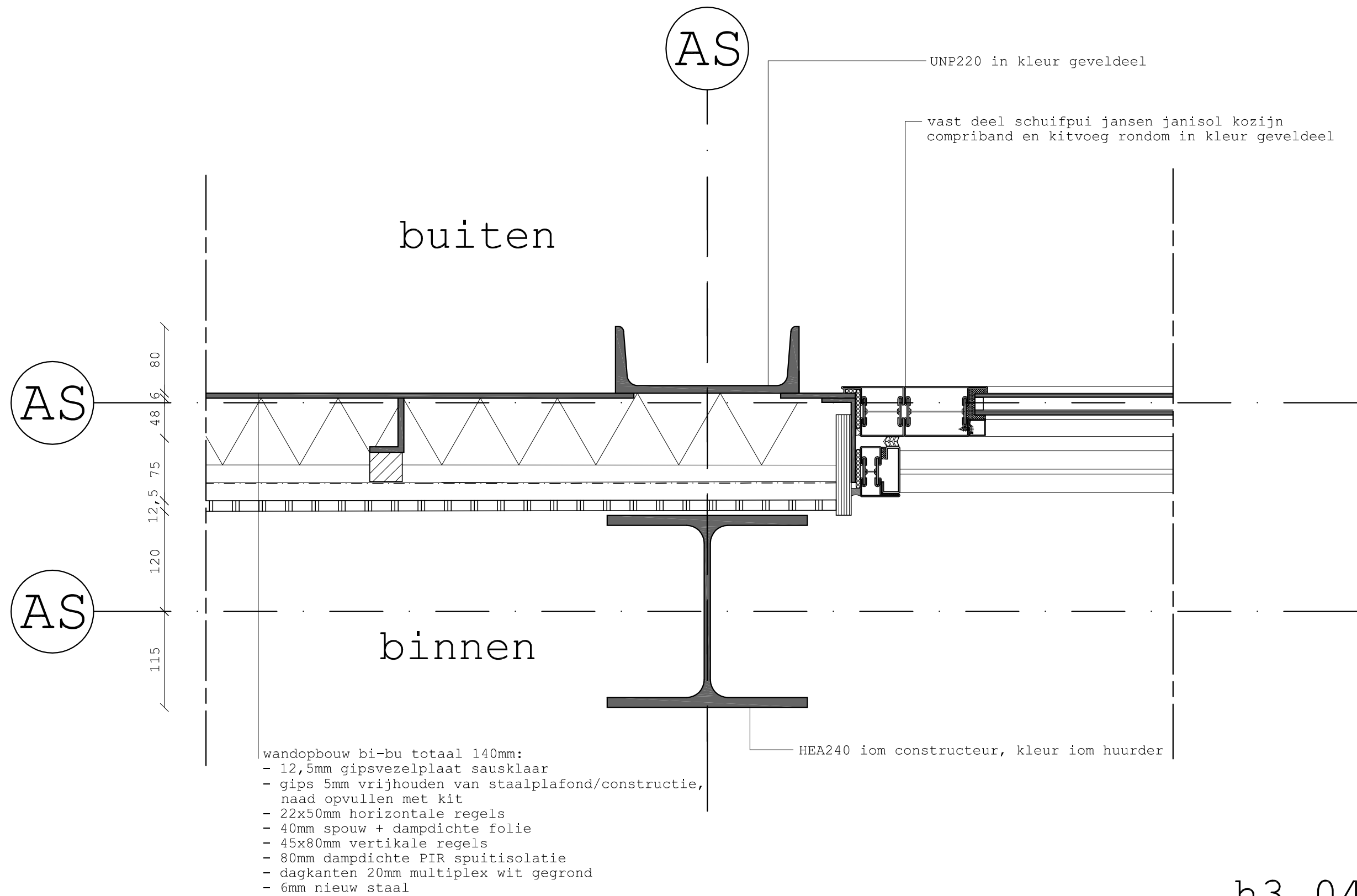

h3.04

horizontaal detail schuivende pui dek-3
restaurant

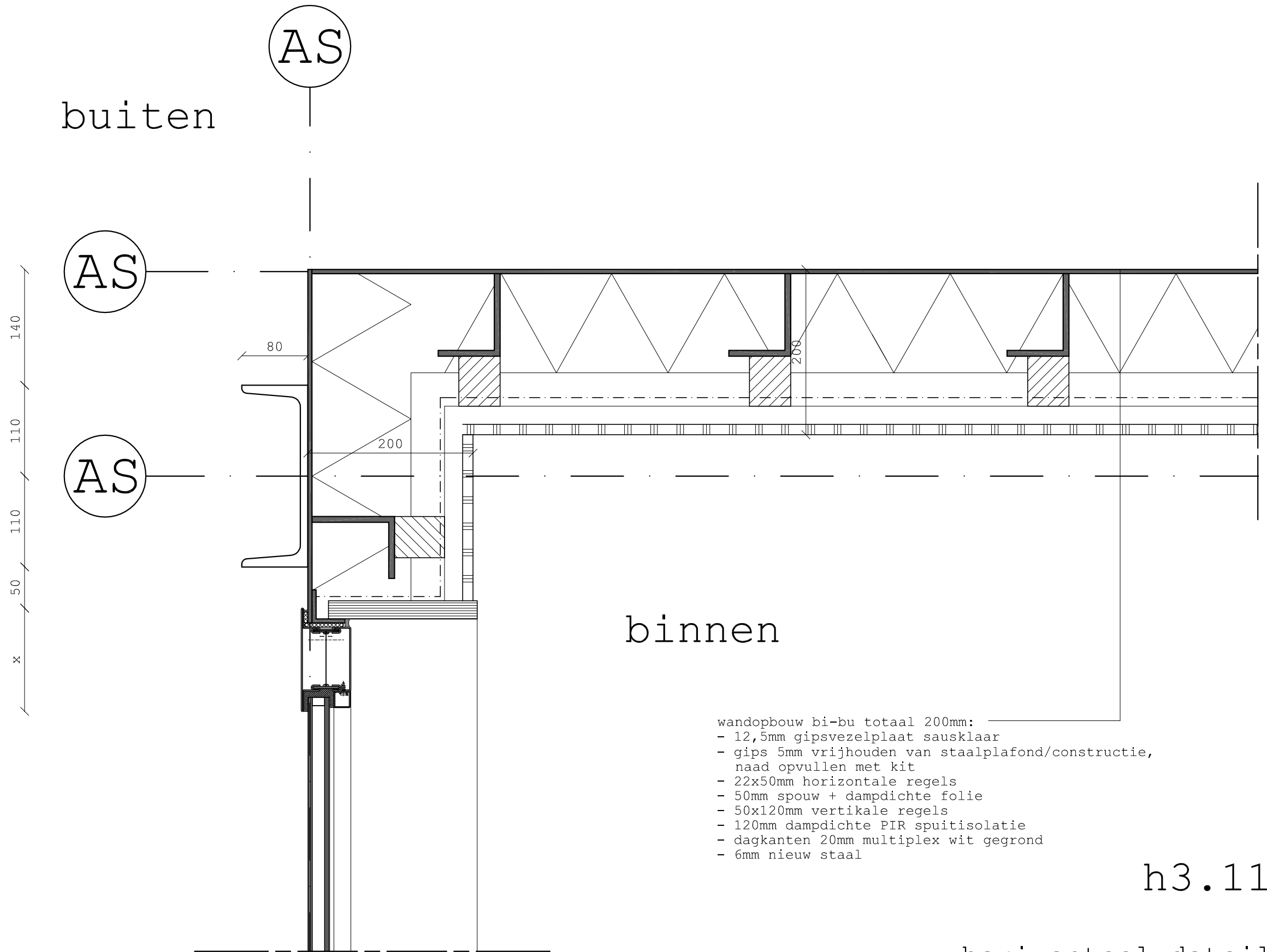

buiten

AS

AS

140
110
110
50
x

AS

binnen

- wandopbouw bi-bu totaal 200mm:
- 12,5mm gipsvezelplaat sausklaar
 - gips 5mm vrijhouden van staalplafond/constructie, naad opvullen met kit
 - 22x50mm horizontale regels
 - 50mm spouw + dampdichte folie
 - 50x120mm verticale regels
 - 120mm dampdichte PIR spuitisolatie
 - dagkanten 20mm multiplex wit gegrond
 - 6mm nieuw staal

h3.11

horizontaal detail
vaste pui dek-3
vide

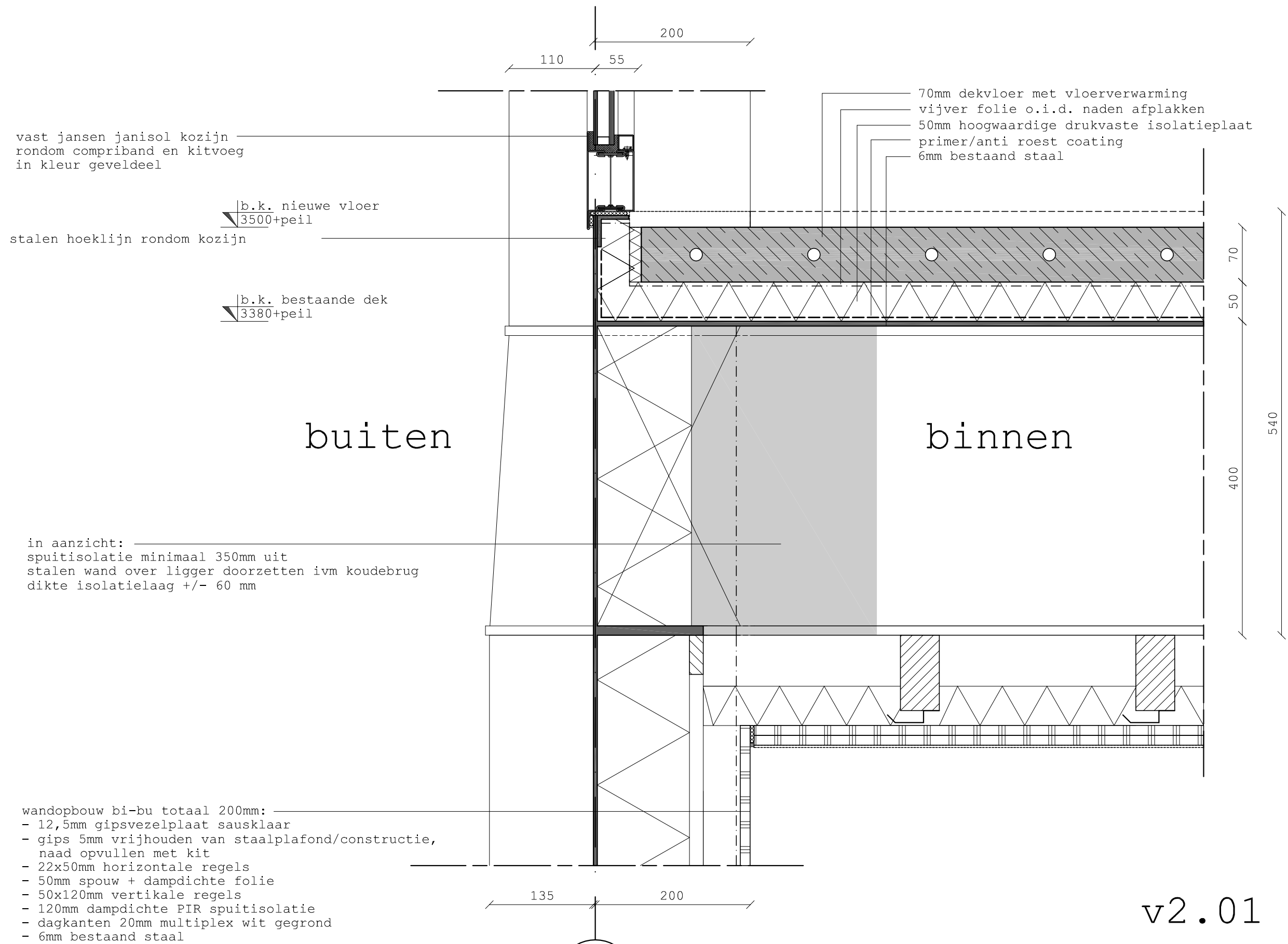

v2.01

AS

verticaal onderdetail vaste pui dek-2
restaurant

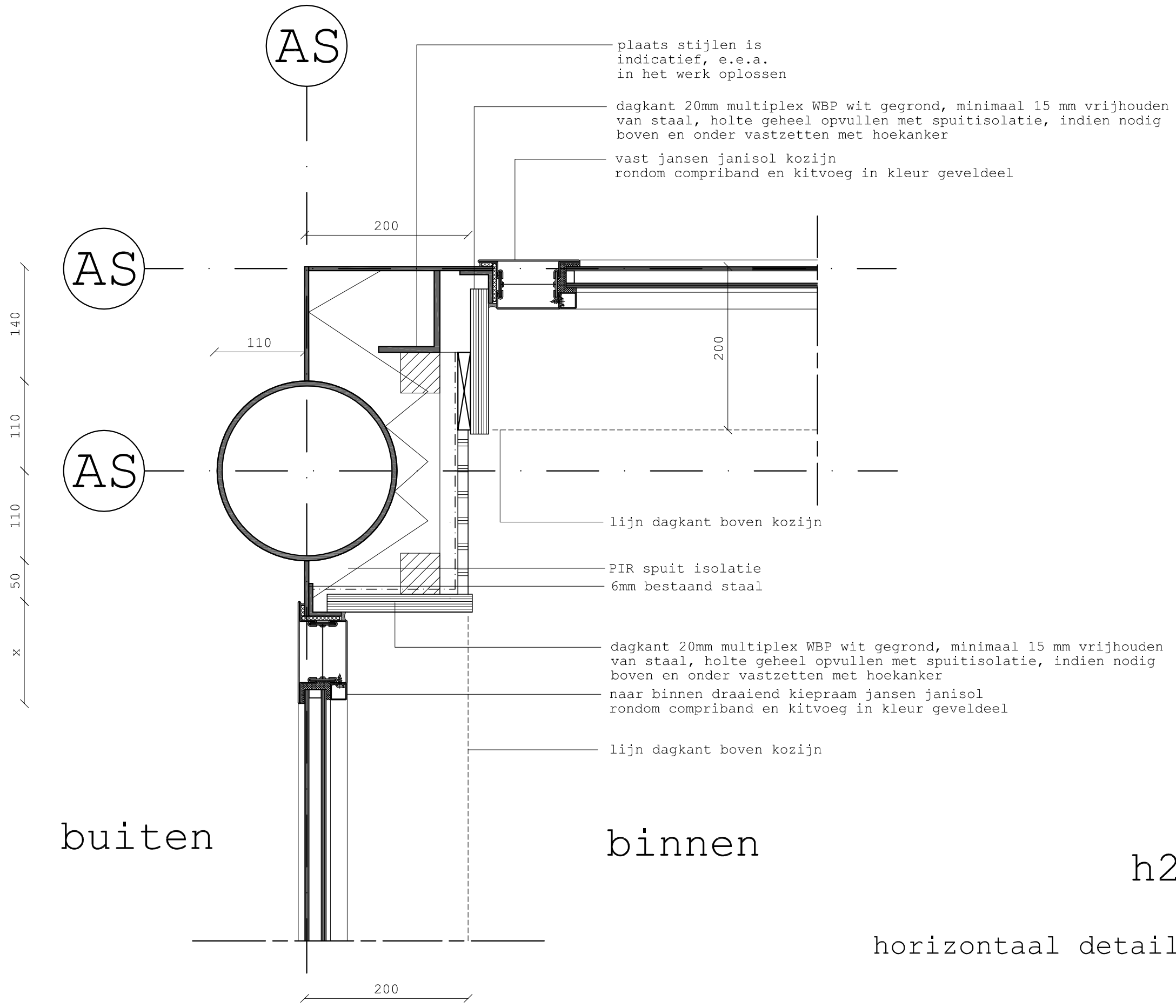

h2.05

horizontaal detail dek-2