

Inkton niet anders vormaat:

- k, wker = +53000
- k kamradelastkor d= 320 + drukslag d= 60-60-80
- gfbachstalen profielbalken d= 605 (S25/S25)
- stalen I-voorzetlaag d= 220 (S25/S25)
- stalen profielbalk d= 220 (S25/S25)
- binnenblad baanwielchielmet
- THQ type B = THQ 200x200-250x40-630x25
- THQ type F = THQ 400x40-250x40-365x20
- THQ 400x44
- L1 = L180x180x16 (S25/S25)
- L2 = L200x200x20
- B0 = Ø244x5x16
- B2 = Ø255x6x20
- B6 = Ø170x5x16
- B8 = Ø188x7x6

Inkton niet anders is aangegaven l.d.v. algemeen:

- voor in te worden voorzien van de beschreven af. wker
- voor openingen in de beschreven af. wker
- trappen en binnenvloeren volgens af. wker
- binnenvloer met vloerplaat (max. 30 cm dikte)

Inkton niet anders is aangegaven l.d.v. staalkonstruatie:

- stalen profielbalken d= 605 (S25/S25)
- stalen I-voorzetlaag d= 220 (S25/S25)
- stalen profielbalk d= 220 (S25/S25)
- binnenblad baanwielchielmet
- THQ type B = THQ 200x200-250x40-630x25
- THQ type F = THQ 400x40-250x40-365x20
- THQ 400x44
- L1 = L180x180x16 (S25/S25)
- L2 = L200x200x20
- B0 = Ø244x5x16
- B2 = Ø255x6x20
- B6 = Ø170x5x16
- B8 = Ø188x7x6

Dies ontwerp is geseheid op bouwvallige gegevens l.d.v. 01-11-2008 (UPL) 14 / 10-2008

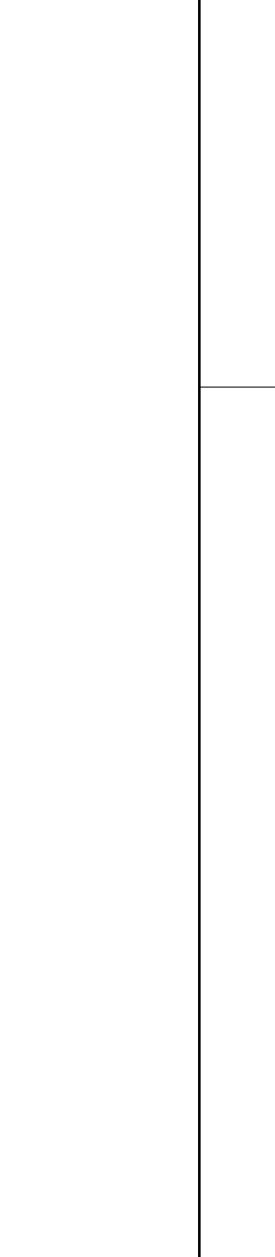
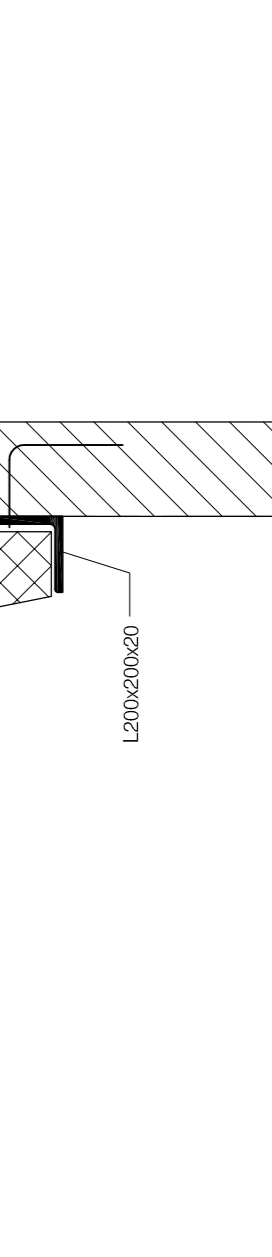
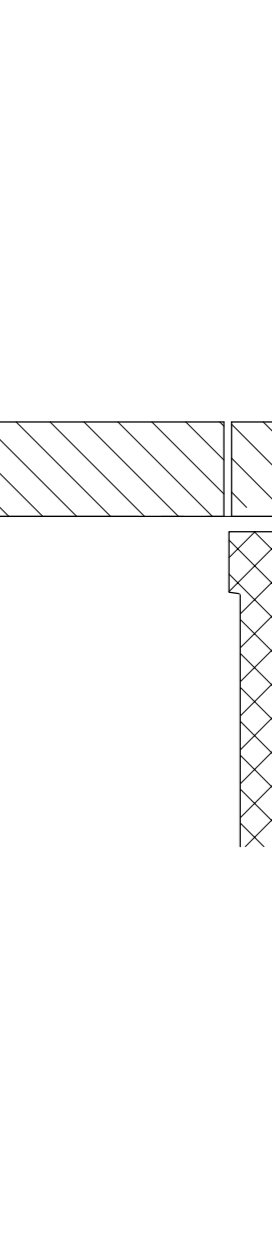
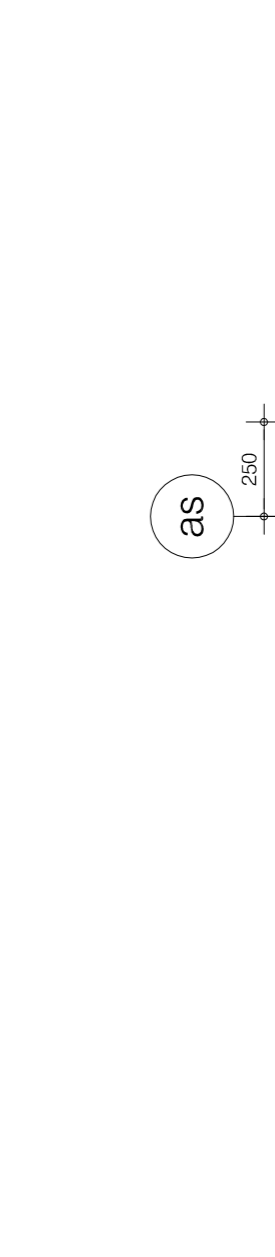
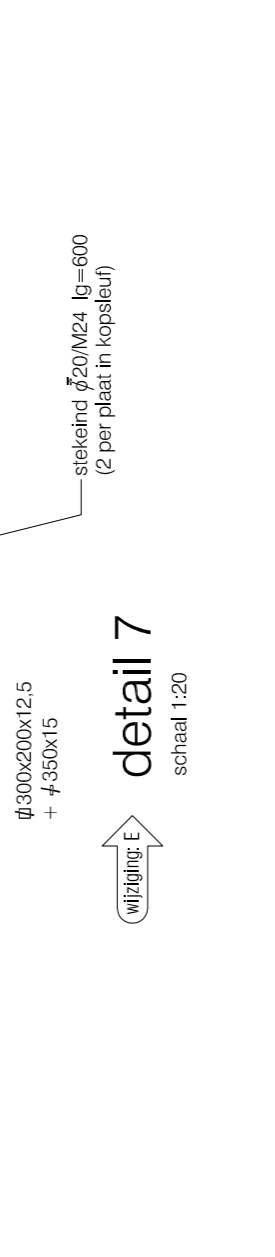
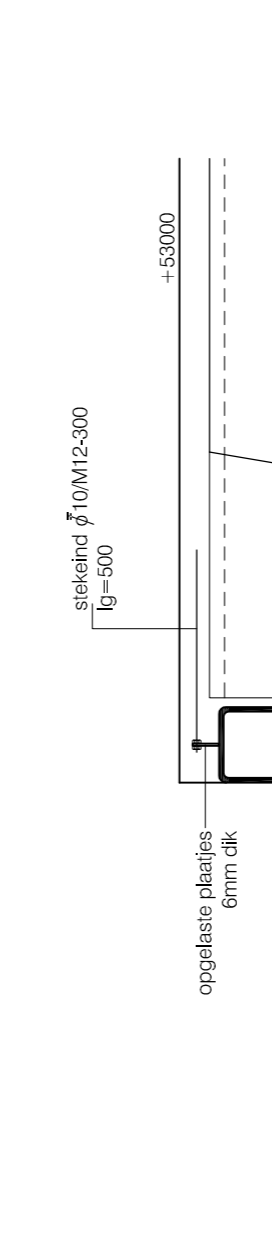
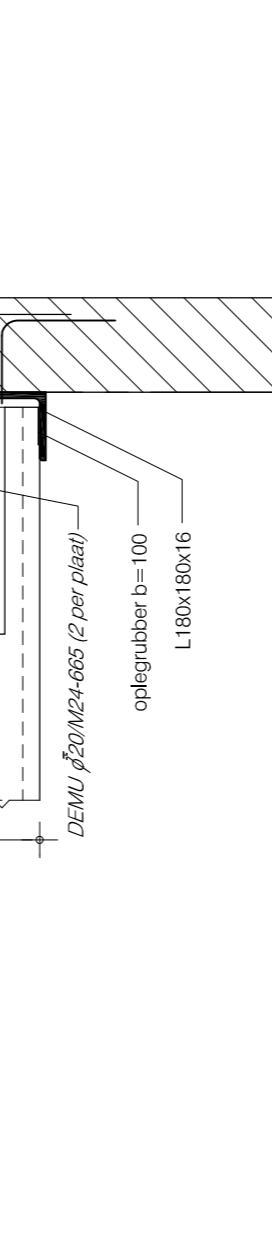
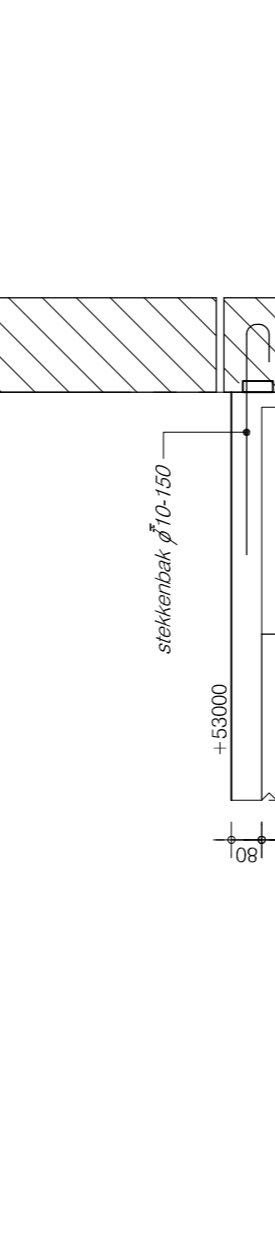
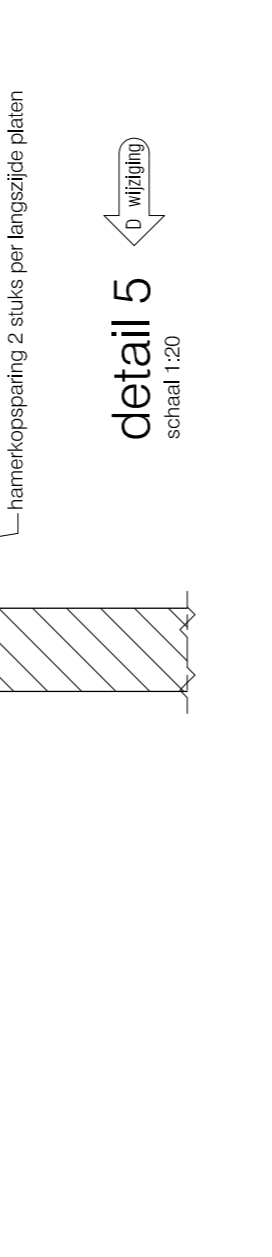
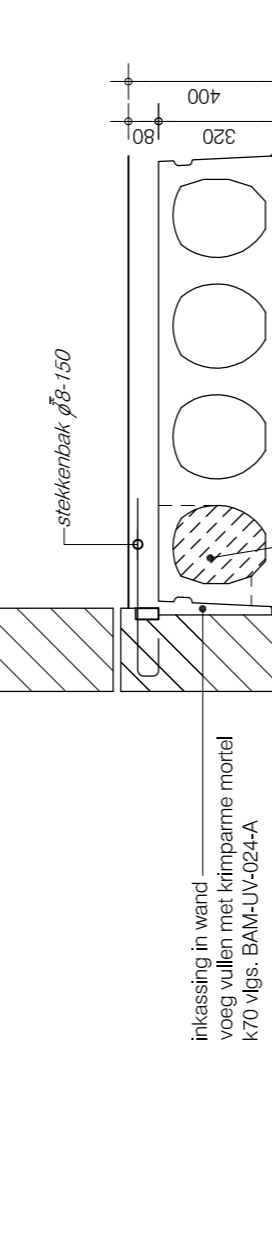
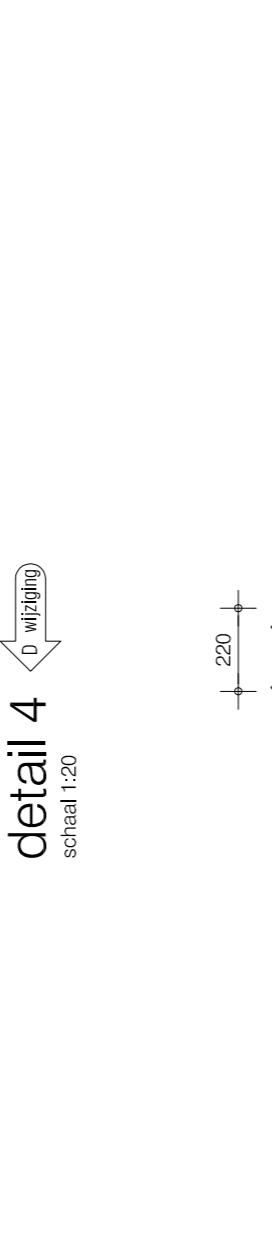
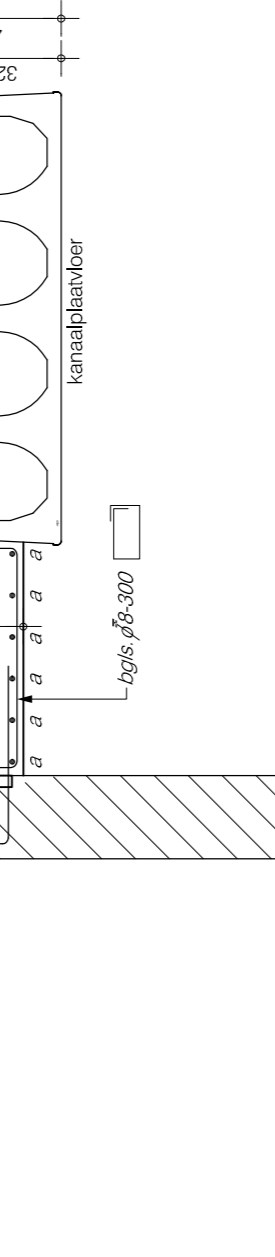
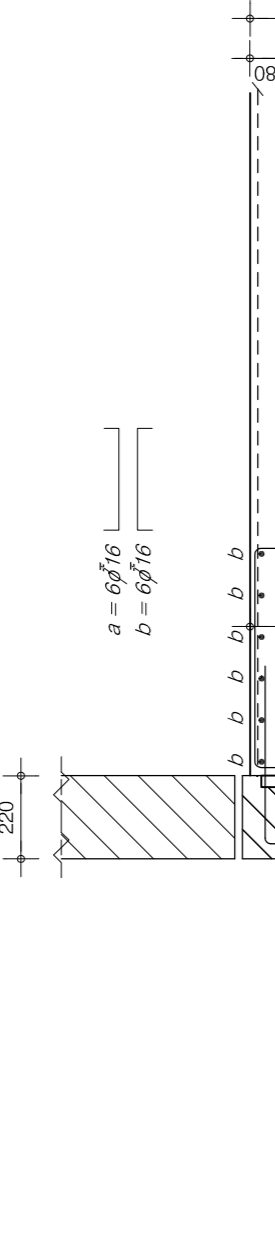
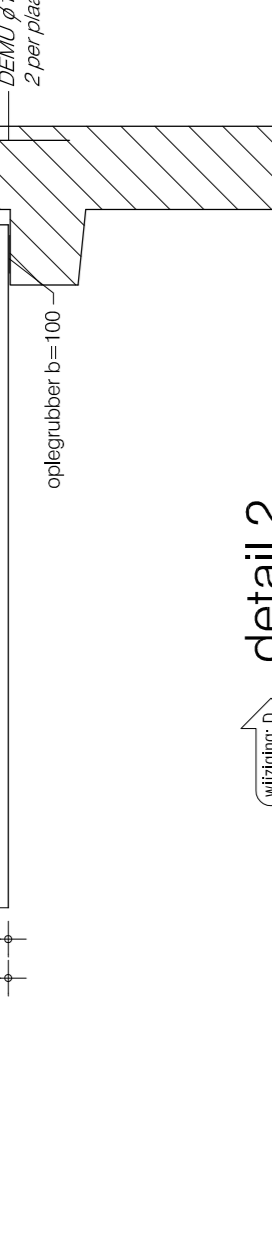
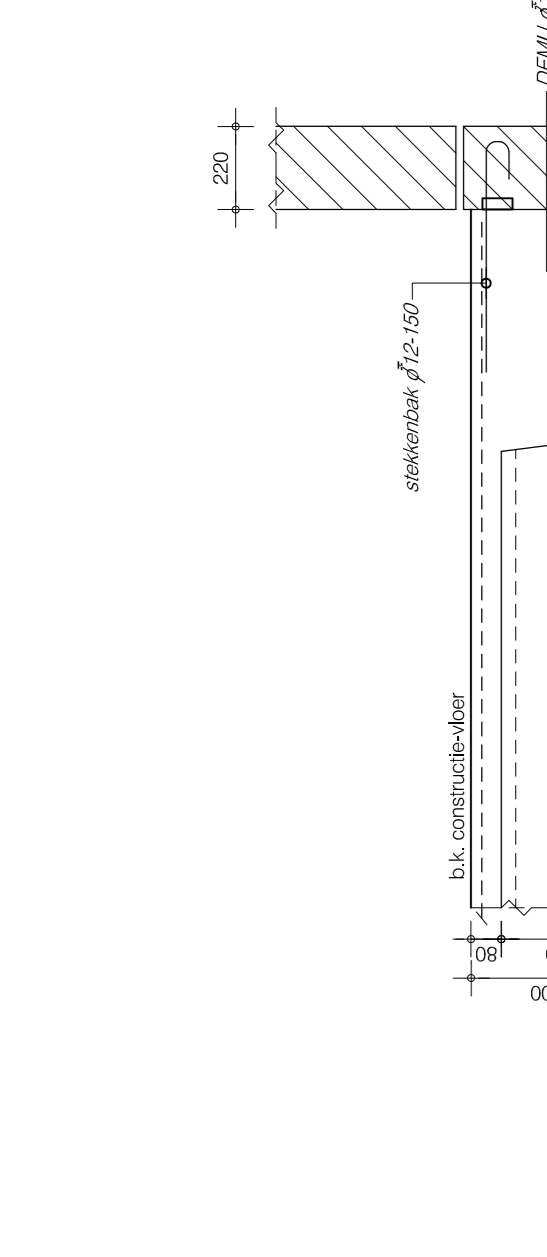
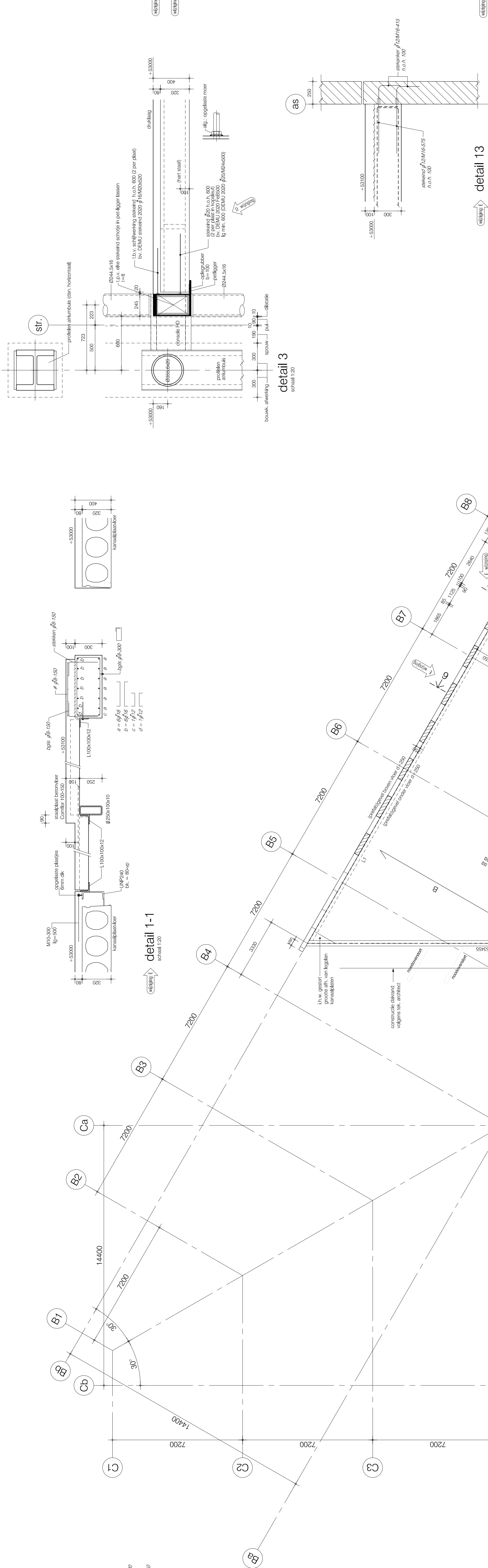

Letter	Algemeen	Specificatie	Aantal
A			
B			
C			
D			
E			
F			
G			
H			
J			
K			
L			
M			
N			
O			
P			
Q			
R			
S			
T			
U			
V			
W			
X			
Y			
Z			

14

STADSKANTOOR LEWIS DEN HAAG

VEERTIENDE VERDIENING

RUWY INTERMARK
ARCHITECTENBUREAU BV
AMSTERDAM

1:100 / 1:20

Atonsohn Constructies
raadadviseurs

1111 200000
1111 200000
1111 200000

1111 200000
1111 200000
1111 200000

1111 200000
1111 200000
1111 200000

1111 200000
1111 200000
1111 200000

1111 200000
1111 200000
1111 200000

1111 200000
1111 200000
1111 200000

1111 200000
1111 200000
1111 200000

1111 200000
1111 200000
1111 200000

1111 200000
1111 200000
1111 200000

1111 200000
1111 200000
1111 200000

1111 200000
1111 200000
1111 200000

1111 200000
1111 200000
1111 200000

