

SECTION A-A

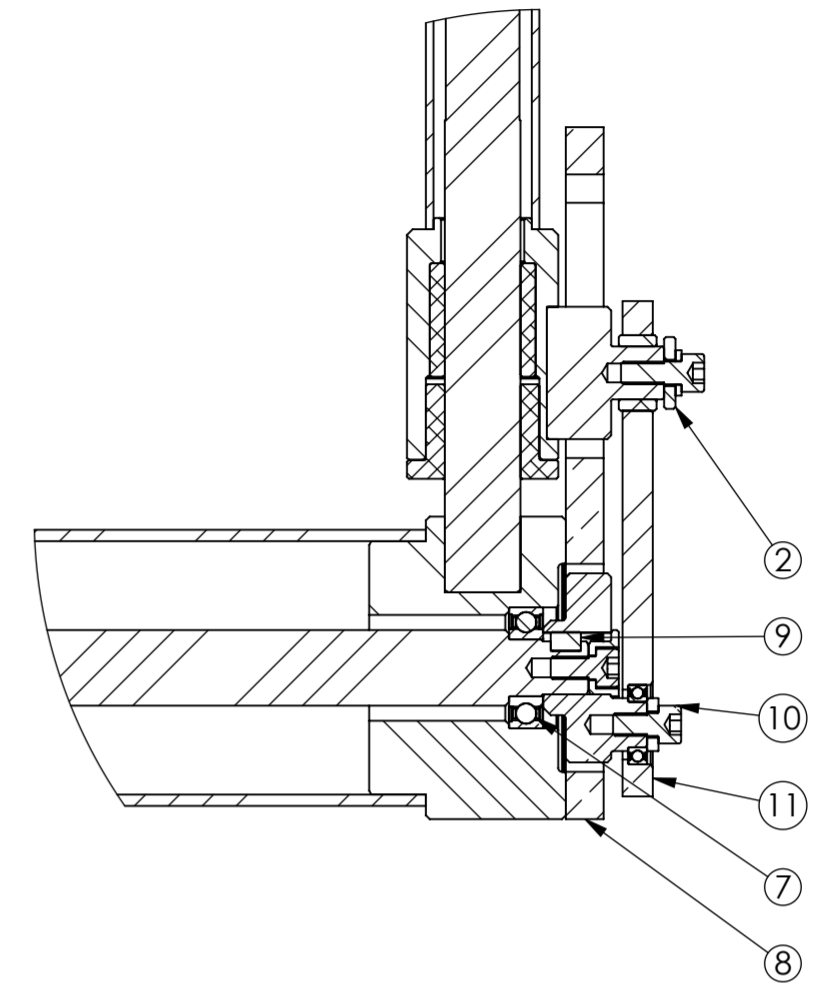

DETAIL B
SCALE 1 : 2

Pos.	Amount	Description	Material	Weight (kg)	Drawing number	Rev.
1	1	Arm vogelmast		24.72	AH1501163	0
2	1	Duwbuis vogelmast assembly		1.05	AH1501173	0
3	1	As vogelmast	1.0037 (S235JR)	2.89	PH1501162	0
4	10	Washer DIN 125 - A 10.5	-	0.00	Washer DIN 125 - A 10.5	0
5	4	DIN 912 M10x45 8.8 ELVZ	-	0.04	DIN 912 M10x45 8.8 ELVZ	0
6	6	DIN 912 M10x30 8.8 ELVZ	-	0.00	DIN 912 M10x30 8.8 ELVZ	0
7	1	Lager 6002-2RSR INA	-	35.43	6002-2RSR INA	0
8	1	Assembly geleideplaat		0.61	AH1501186	0
9	1	Parallel key DIN 6885 5x5x8	-	0.00	Parallel key DIN 6885 5 x 5 x 8	0
10	1	Excentriek assembly		0.21	AH1501182	0
11	1	Drijfstang assembly		0.26	AH1501180	0

COPIER ENGINEERING BV
ENGINEERING

Bedrijvenstraat 13
4283 JJ Giessen

Tel. 0183-441313
Fax 0183-448028

This drawing is property of COPIER ENGINEERING BV. Reproduction or disclosure to third parties in any form whatsoever is not allowed without explicit written consens of COPIER ENGINEERING BV.

Projection:

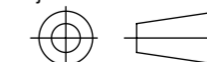

Scale:

1:5

Creation date:

9-12-2015

Draftsman:

PR

Client:

location:

Revision date:

Project:

E1040

Description:

Assembly arm vogelmast

Amount:

1

Drawing number:

AH1501172

Revision:

0