

PLAN AT SOUTH BANK OVERALL PLAN
SCALE 1:100

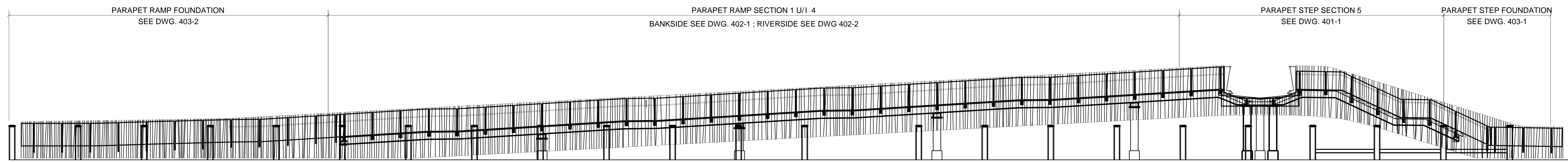

SECTION A - A

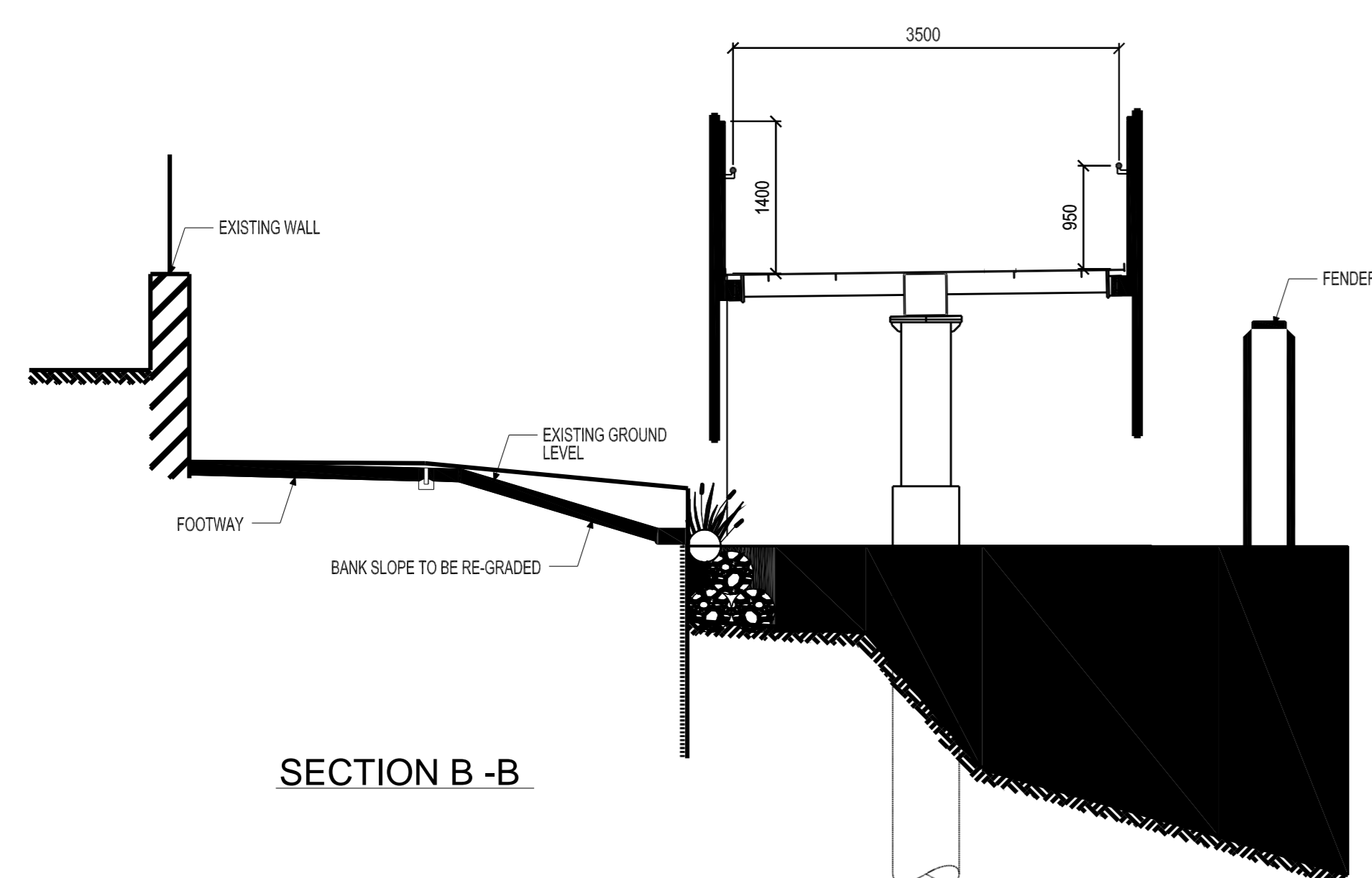

SECTION B - B

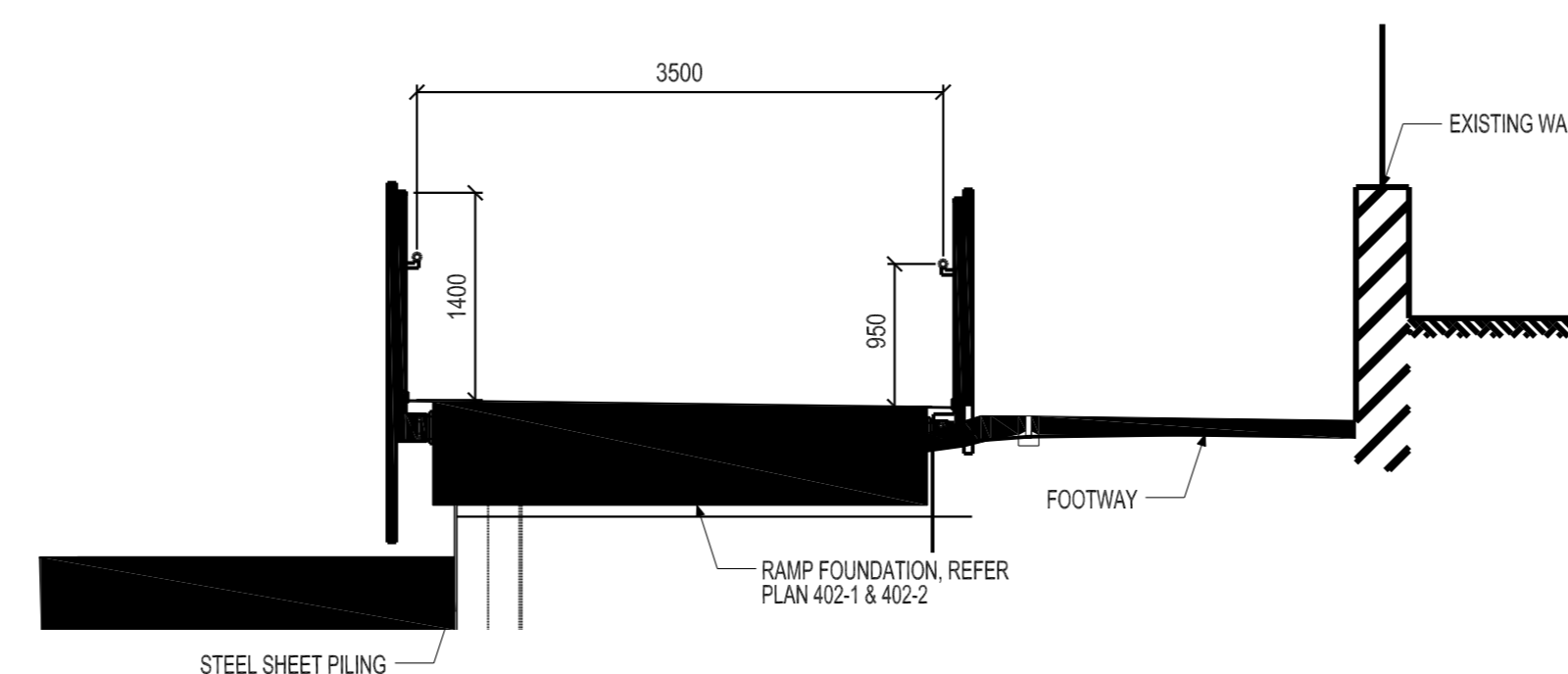

SECTION C - C

A	FOR CONSTRUCTION	01.07.2015	LIZA
0	FOR APPROVAL	23.06.2015	LIZA
Rev. no.	Revisie omschrijving	Revisie datum	Tek. Gew.
Status		Projectleider	E.H.
Architect		Schaal	1:100
Aannemer		Getek	Taufik
Opdrachtgever:	Balfour Beatty PLC	Datum	
Klant	READING BOROUGH COUNCIL	Projectie:	
Werklocatie	RIVER THAMES, READING	Exc.kl.	3
Omschr. Order	PEDESTRIAN / CYCLE BRIDGE	Lassen	minimaal a=6 L.a.v.



JOS VAN DEN BERSELAAR
CONSULTANTS



Baarsstraat 2 - 5071 NM Udenhout - Postbus 17 - 5270 AA Udenhout
tel. 013 - 5117400 - Fax 013 - 5117400
E-mail: info@berseelaar.com - Internet: www.berseelaar.com

RIVER THAMES, READING
PEDESTRIAN / CYCLE BRIDGE
SOUTH BANK RAMP & STEPS
OVERALL PLAN

Verk. regelnr. **32101-2002**

Tek.: **100**

Eigendom uitsluitend voorbehouden. Vermenging, of mededeling in welke vorm ook, is zonder schriftelijke toestemming niet geoorloofd.

EN 1090
EXCH GECERTIFICEERD

Formaat: 1189x841 Teknis Structures model Reading-P-C Bridge geprikt op: 17.08.2015